

# SPROCKETS AUSTRALIA PTY LTD

SPROCKETS FOR ROLLER CHAINS - DIN 8187 - ISO 606

**1/2" x 5/16"**  
**12,7 x 7,75 mm**  
 Roller 8,51 mm  
**08B - 1 - 2 - 3**

| B1  | B2 | B3   | b1 | C   | r3 |
|-----|----|------|----|-----|----|
| 7,2 | 21 | 34,9 | 7  | 1,3 | 13 |

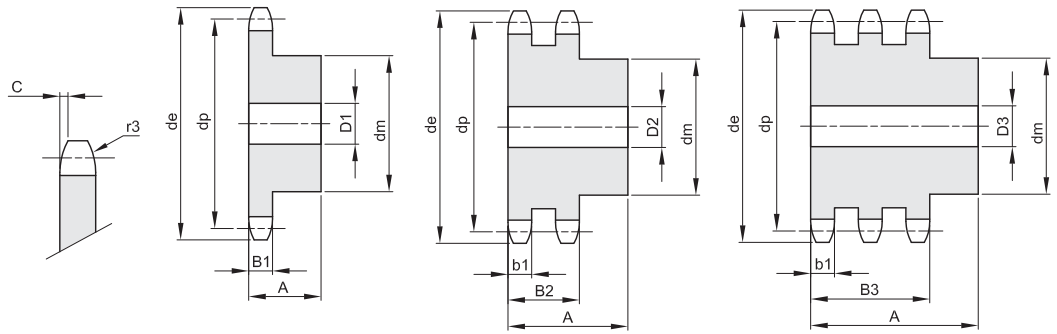

| Z  | de    | dp     | simplex |    |    |      | duplex |    |    |       | triplex |    |    |       |
|----|-------|--------|---------|----|----|------|--------|----|----|-------|---------|----|----|-------|
|    |       |        | dm      | D1 | A  | Kg.  | dm     | D2 | A  | Kg.   | dm      | D3 | A  | Kg.   |
| 8  | 38,0  | 33,18  | 20      | 10 | 25 | 0,06 | 20     | 10 | 32 | 0,09  | 20      | 10 | 46 | 0,13  |
| 9  | 42,0  | 37,13  | 24      | 10 | 25 | 0,09 | 24     | 10 | 32 | 0,13  | 24      | 12 | 46 | 0,18  |
| 10 | 45,9  | 41,10  | 26      | 10 | 25 | 0,12 | 28     | 10 | 32 | 0,18  | 28      | 12 | 46 | 0,24  |
| 11 | 49,9  | 45,07  | 29      | 10 | 25 | 0,15 | 32     | 12 | 35 | 0,24  | 32      | 16 | 50 | 0,31  |
| 12 | 53,9  | 49,07  | 33      | 10 | 28 | 0,21 | 35     | 12 | 35 | 0,30  | 35      | 16 | 50 | 0,39  |
| 13 | 57,9  | 53,06  | 37      | 10 | 28 | 0,26 | 38     | 12 | 35 | 0,36  | 38      | 16 | 50 | 0,49  |
| 14 | 61,9  | 57,07  | 41      | 10 | 28 | 0,32 | 42     | 12 | 35 | 0,44  | 42      | 16 | 50 | 0,60  |
| 15 | 65,9  | 61,09  | 45      | 10 | 28 | 0,38 | 46     | 12 | 35 | 0,52  | 46      | 16 | 50 | 0,72  |
| 16 | 69,9  | 65,10  | 50      | 12 | 28 | 0,46 | 50     | 16 | 38 | 0,63  | 50      | 16 | 50 | 0,85  |
| 17 | 74,0  | 69,11  | 52      | 12 | 28 | 0,51 | 54     | 16 | 38 | 0,73  | 54      | 16 | 50 | 0,99  |
| 18 | 78,0  | 73,14  | 56      | 12 | 28 | 0,59 | 58     | 16 | 38 | 0,85  | 58      | 16 | 50 | 1,14  |
| 19 | 82,0  | 77,16  | 60      | 12 | 28 | 0,67 | 62     | 16 | 38 | 0,97  | 62      | 16 | 50 | 1,30  |
| 20 | 86,0  | 81,19  | 64      | 12 | 28 | 0,76 | 66     | 16 | 38 | 1,10  | 66      | 16 | 50 | 1,47  |
| 21 | 90,1  | 85,22  | 68      | 14 | 28 | 0,85 | 70     | 16 | 40 | 1,29  | 70      | 16 | 55 | 1,79  |
| 22 | 94,1  | 89,24  | 70      | 14 | 28 | 0,91 | 70     | 16 | 40 | 1,37  | 70      | 16 | 55 | 1,93  |
| 23 | 98,1  | 93,27  | 70      | 14 | 28 | 0,95 | 70     | 16 | 40 | 1,46  | 70      | 16 | 55 | 2,08  |
| 24 | 102,1 | 97,29  | 70      | 14 | 28 | 0,98 | 75     | 16 | 40 | 1,64  | 75      | 16 | 55 | 2,32  |
| 25 | 106,2 | 101,33 | 70      | 14 | 28 | 1,01 | 80     | 16 | 40 | 1,82  | 80      | 16 | 55 | 2,57  |
| 26 | 110,2 | 105,36 | 70      | 16 | 30 | 1,09 | 85     | 16 | 40 | 2,02  | 85      | 20 | 55 | 2,79  |
| 27 | 114,2 | 109,40 | 70      | 16 | 30 | 1,13 | 85     | 16 | 40 | 2,12  | 85      | 20 | 55 | 2,96  |
| 28 | 118,3 | 113,42 | 70      | 16 | 30 | 1,17 | 90     | 16 | 40 | 2,34  | 90      | 20 | 55 | 3,25  |
| 29 | 122,3 | 117,46 | 80      | 16 | 30 | 1,42 | 95     | 16 | 40 | 2,56  | 95      | 20 | 55 | 3,55  |
| 30 | 126,3 | 121,50 | 80      | 16 | 30 | 1,46 | 100    | 16 | 40 | 2,79  | 100     | 20 | 55 | 3,86  |
| 31 | 130,4 | 125,54 | 90      | 16 | 30 | 1,74 | 100    | 20 | 40 | 2,87  | 110     | 20 | 55 | 4,32  |
| 32 | 134,4 | 129,56 | 90      | 16 | 30 | 1,78 | 100    | 20 | 40 | 3,00  | 110     | 20 | 55 | 4,53  |
| 33 | 138,4 | 133,60 | 90      | 16 | 30 | 1,83 | 100    | 20 | 40 | 3,13  | 110     | 20 | 55 | 4,74  |
| 34 | 142,5 | 137,64 | 90      | 16 | 30 | 1,88 | 100    | 20 | 40 | 3,26  | 110     | 20 | 55 | 4,97  |
| 35 | 146,5 | 141,68 | 90      | 16 | 30 | 1,93 | 100    | 20 | 40 | 3,40  | 110     | 20 | 55 | 5,20  |
| 36 | 150,6 | 145,72 | 90      | 16 | 35 | 2,22 | 100    | 20 | 40 | 3,54  | 120     | 25 | 55 | 5,64  |
| 37 | 154,6 | 149,76 | 90      | 16 | 35 | 2,27 | 100    | 20 | 40 | 3,69  | 120     | 25 | 55 | 5,88  |
| 38 | 158,6 | 153,80 | 90      | 16 | 35 | 2,32 | 100    | 20 | 40 | 3,84  | 120     | 25 | 55 | 6,14  |
| 39 | 162,7 | 157,83 | 90      | 16 | 35 | 2,38 | 100    | 20 | 40 | 4,00  | 120     | 25 | 55 | 6,40  |
| 40 | 166,7 | 161,87 | 90      | 16 | 35 | 2,43 | 100    | 20 | 40 | 4,15  | 120     | 25 | 55 | 6,66  |
| 42 | 176,5 | 169,95 | *88     | 20 | 42 | 2,77 | *108   | 20 | 55 | 5,67  |         |    |    |       |
| 45 | 188,6 | 182,07 | *88     | 20 | 42 | 3,00 | *108   | 20 | 55 | 6,26  | *120    | 25 | 68 | 9,12  |
| 46 | 192,6 | 186,10 | *88     | 20 | 42 | 3,06 | *108   | 20 | 55 | 6,39  |         |    |    |       |
| 48 | 200,7 | 194,18 | *88     | 20 | 42 | 3,16 | *108   | 20 | 55 | 6,75  |         |    |    |       |
| 50 | 208,8 | 202,26 | *88     | 20 | 42 | 3,30 | *108   | 20 | 55 | 7,17  | *120    | 25 | 68 | 10,74 |
| 55 | 229,0 | 222,46 | *88     | 20 | 42 | 3,62 |        |    |    |       |         |    |    |       |
| 57 | 237,1 | 230,54 | *88     | 20 | 42 | 3,85 | *108   | 25 | 55 | 8,65  | *120    | 25 | 68 | 13,26 |
| 60 | 249,2 | 242,66 | *88     | 20 | 42 | 4,08 | *108   | 25 | 55 | 9,35  | *120    | 25 | 68 | 14,47 |
| 76 | 313,9 | 307,33 | *88     | 25 | 42 | 5,56 | *108   | 25 | 55 | 13,30 | *120    | 25 | 68 | 21,78 |
| 95 | 390,7 | 384,11 | *108    | 25 | 42 | 8,56 | *120   | 25 | 55 | 21,13 | *136    | 25 | 68 | 34,00 |

Please note: Length through bore and bore size may vary from time to time.