

SPROCKETS AUSTRALIA PTY LTD

SPROCKETS FOR ROLLER CHAINS - DIN 8188 - ISO 606 - ANSI B 29.1

ASA 60

19,05 x 12,7 mm
Roller 11,91 mm

B1	B2	B3	b1	C	r3
11,6	34,1		11,3	2,4	20

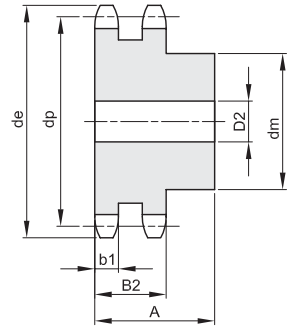
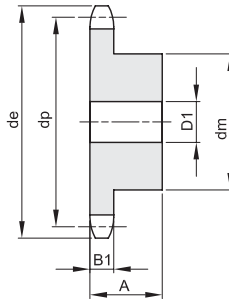
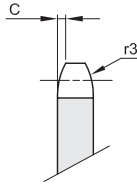

Z	de	dp	Simplex				Duplex			
			dm	D1	A	Kg.	dm	D2	A	Kg.
8	58,1	49,78								
9	64,0	55,70								
10	70,0	61,64	42	12	30	0,38	42	16	45	0,58
11	76,0	67,61	46	16	35	0,50	47	16	50	0,80
12	81,9	73,60	52	16	35	0,64	53	16	50	1,01
13	87,9	79,59	58	16	35	0,80	59	16	50	1,24
14	94,0	85,61	64	16	35	0,97	65	16	50	1,45
15	100,0	91,63	70	16	35	1,16	71	16	50	1,73
16	106,0	97,65	75	16	35	1,34	77	20	50	2,03
17	112,0	103,67	80	16	35	1,53	83	20	50	2,35
18	118,0	109,71	80	16	35	1,61	89	20	50	2,70
19	124,1	115,75	80	16	35	1,70	95	20	50	3,06
20	130,1	121,78	80	16	35	1,84	100	20	50	3,45
21	136,2	127,82	90	20	40	2,35	100	20	50	3,69
22	142,2	133,86	90	20	40	2,45	100	20	50	3,96
23	148,2	139,90	90	20	40	2,56	110	20	50	4,50
24	154,3	145,94	90	20	40	2,67	110	20	50	4,81
25	160,3	152,00	90	20	40	2,79	120	20	50	5,40
26	166,4	158,04	95	20	40	3,08	120	20	50	5,73
27	172,4	164,09	95	20	40	3,21				
28	178,5	170,13	95	20	40	3,34	120	20	50	6,43
29	184,5	176,19								
30	190,6	182,25	95	20	40	3,62	120	20	50	7,18
31	196,6	188,31								
32	202,7	194,35	95	20	40	3,92				
33	208,8	200,40								
34	214,8	206,46	95	20	40	4,25				
35	220,9	212,52	95	20	40	4,41				
36	226,9	218,58	95	20	40	4,71				
37	233,0	224,64								
38	239,0	230,69	100	20	40	5,07				
39	245,1	236,75								
40	251,1	242,81	100	20	40	5,45				

Please note: Length through bore and bore size may vary from time to time.

